

How to Make a Parchment Pastry Bag

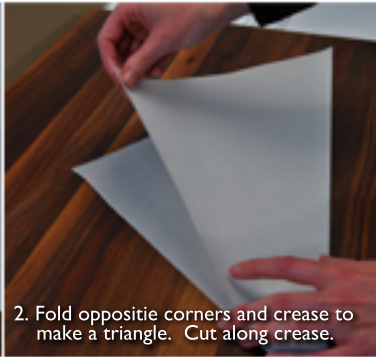

1. Tear sheet of Parchment Paper.



2. Fold opposite corners and crease to make a triangle. Cut along crease.



3. Lay triangle with base closest to you.

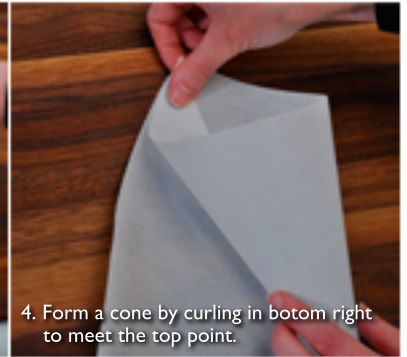

4. Form a cone by curling in bottom right to meet the top point.



12. Squeeze to decorate.



5. Wrap the bottom left around the cone to meet at the top.



6. Make a tight tip on the cone by adjusting the 3 points.

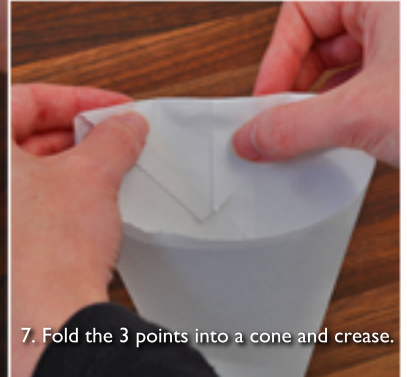

7. Fold the 3 points into a cone and crease.



11. Snip off the tip of the cone.



10. Fill bag 1/2 with frosting & push down toward the tip & roll like toothpaste.



9. Tear a notch to hold the fold in place.



8. Make a second fold.